



CRC Construction Innovation  
BUILDING OUR FUTURE

# Update

newsletter – March 2007

[www.construction-innovation.info](http://www.construction-innovation.info)

## See you at the RAIA conference!

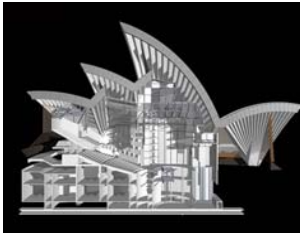

Image courtesy Arup & Johnson Pilton Walker JPW. Copyright Sydney Opera House.

Construction Innovation is proud to be a sponsor of the [2007 National Architecture Conference](#), to be held in Melbourne 19-22 April.

CEO Professor Keith Hampson will introduce a session in the Towards Integrated Practice Stream about the Sydney Opera House FM Exemplar project on Friday 20 April. [More details](#)

## Managing Relationships course success



Fifteen John Holland staff participated in a two-day relationship management course, held in Brisbane 1-2 March.

The course was run by *Construction Innovation* and the content had been specifically structured to meet the needs of John Holland staff. [More details](#)

## Water online at RAIA

*Construction Innovation* has collaborated with the Royal Australian Institute of Architects to offer an accredited online course on integrated water services for architects and related professionals. [More details](#)



## Continuing impact of Sustainable Subdivisions report



Recent [national media coverage](#) on *Construction Innovation's Sustainable Subdivisions: Energy Efficient Design* research project highlights the considerable impact this project continues to have. [More details](#)

## Events

### RAIA—National Architecture Conference

19-22 April, Melbourne

Don't miss *Construction Innovation's* ICT tools showcase at the RAIA conference! [More details](#)

Relationship Management Course at Queensland Department of Public Works. 18-19 April. [More details](#)

## From the CEO's desk



### Like water, safety requires a national approach

Despite improvements in construction over the past 20 years, the industry's fatality rate remains unacceptably high.

Construction site labour makes up eight percent of the Australian workforce but accounts for more than 15% of all fatalities in the workplace. On average one person is killed on a construction site each week in Australia. Thousands more are seriously injured.

According to figures released by the Australian Safety and Compensation Council for 2003-2004, the fatality rate in the construction sector equates to a 6.7 fatality rate per 100,000. The figure is probably even higher when you take into account disease-related deaths. The construction fatality rate is an estimated five times higher than the mining industry.

Clearly there is a need to articulate a shared vision across industry and government to guide effective principles and practices that will improve safety.... [More details](#)

To be removed from our mailing list: [enquiries@construction-innovation.info](mailto:enquiries@construction-innovation.info) or 61-7-3138 9291